

外形安装尺寸 Mounting Dimension Sheets-overview

R97

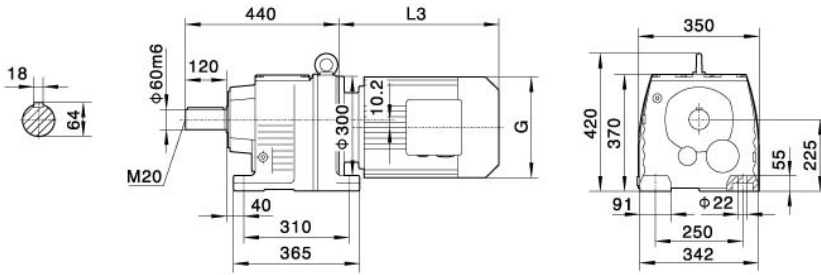

电机需方配时或配特殊电机时需加联接法兰
When equipping the user's motor or the special one, the flange is required to be connected.

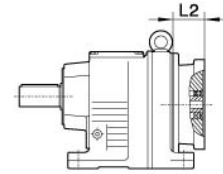

RF97

Φ350

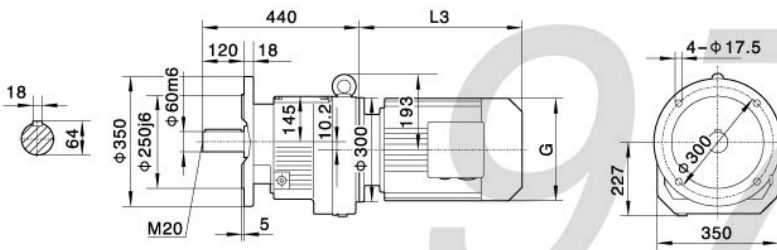

R..S97

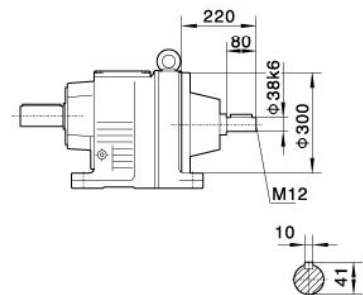

Φ450

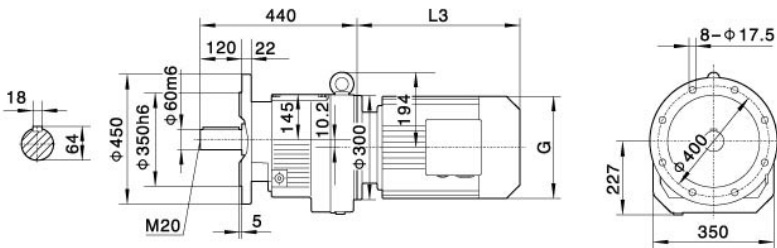

R..97R57

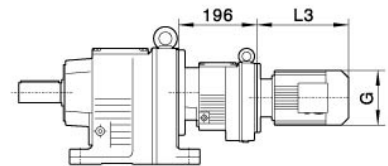

注：其余尺寸见相应的结构形式
Note: For other values please refer to the opposite structure

| Y ₂ 电机机座号 Motor size | 80 | 90S | 90L | 100 | 112M | 132S | 132M | 160M | 160L | 180M | 180L | 200 | | |
|------------------------------------|------|------|-----|-----|------|------|------|------|------|------|------|------|----|----|
| 功率/4P Power/(kW) | 0.55 | 0.75 | 1.1 | 1.5 | 2.2 | 3.0 | 4.0 | 5.5 | 7.5 | 11 | 15 | 18.5 | 22 | 30 |
| L3 | 246 | 280 | 304 | 315 | 334 | 425 | 461 | 524 | 547 | 555 | 588 | 654 | | |
| G | 175 | 195 | 195 | 215 | 240 | 275 | 275 | 330 | 330 | 380 | 380 | 420 | | |
| L2 | 86 | 86 | 86 | 101 | 101 | 101 | 101 | 126 | 126 | 126 | 126 | 132 | | |

注：“R..”表示R、RF

Note:“R..”mean R、RF

R